

\* Predisposition recess channel provided by the customer

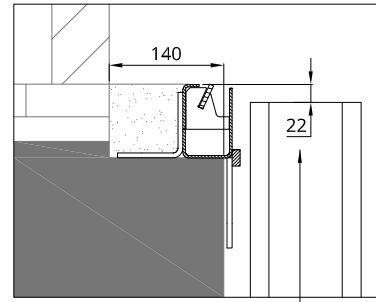

**IMPORTANT: Position guides observing the dimension indicated by the channel and check 573 from the downstairs level**

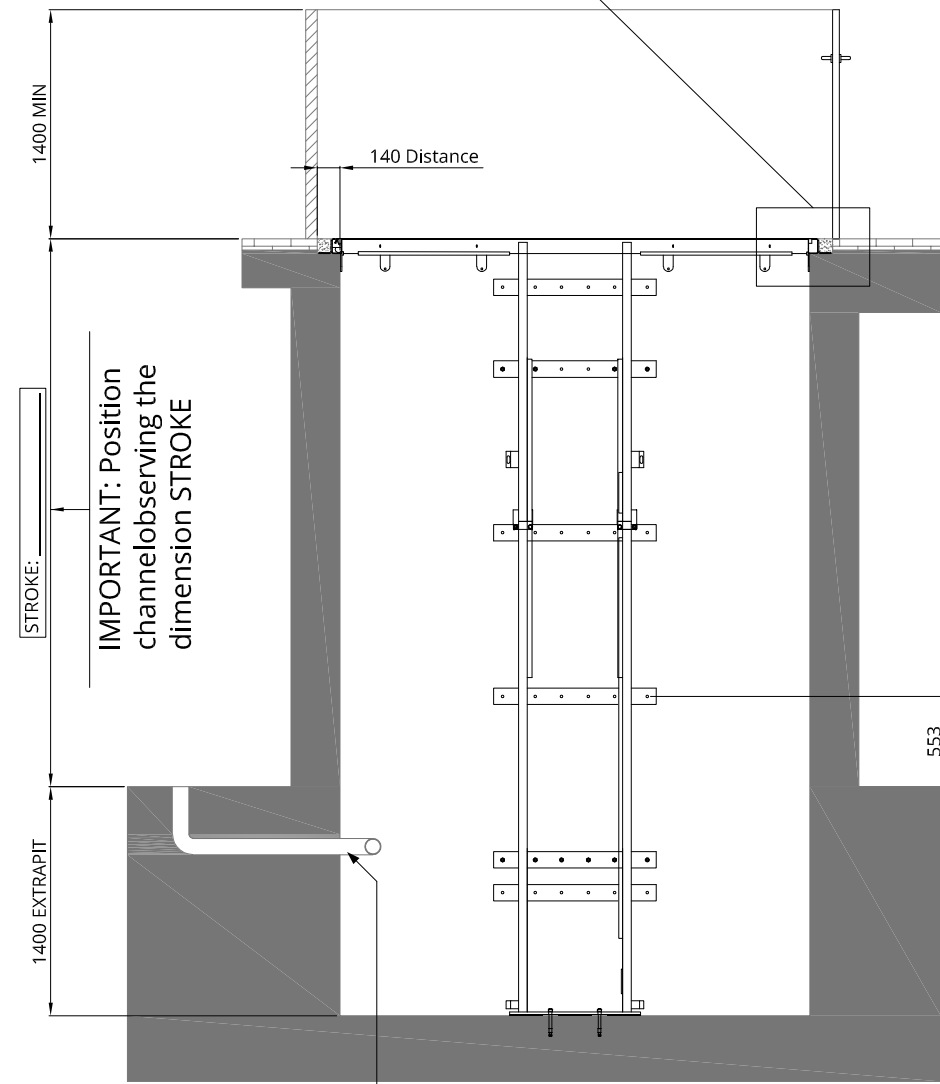
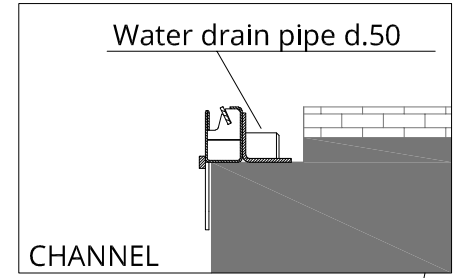
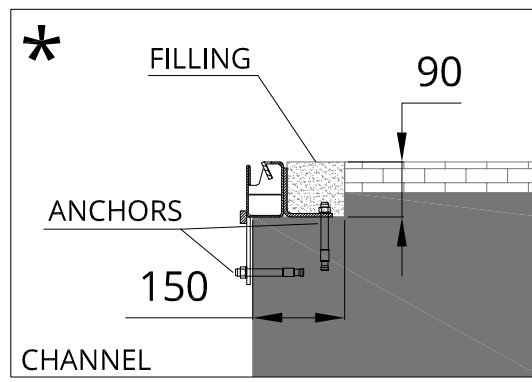
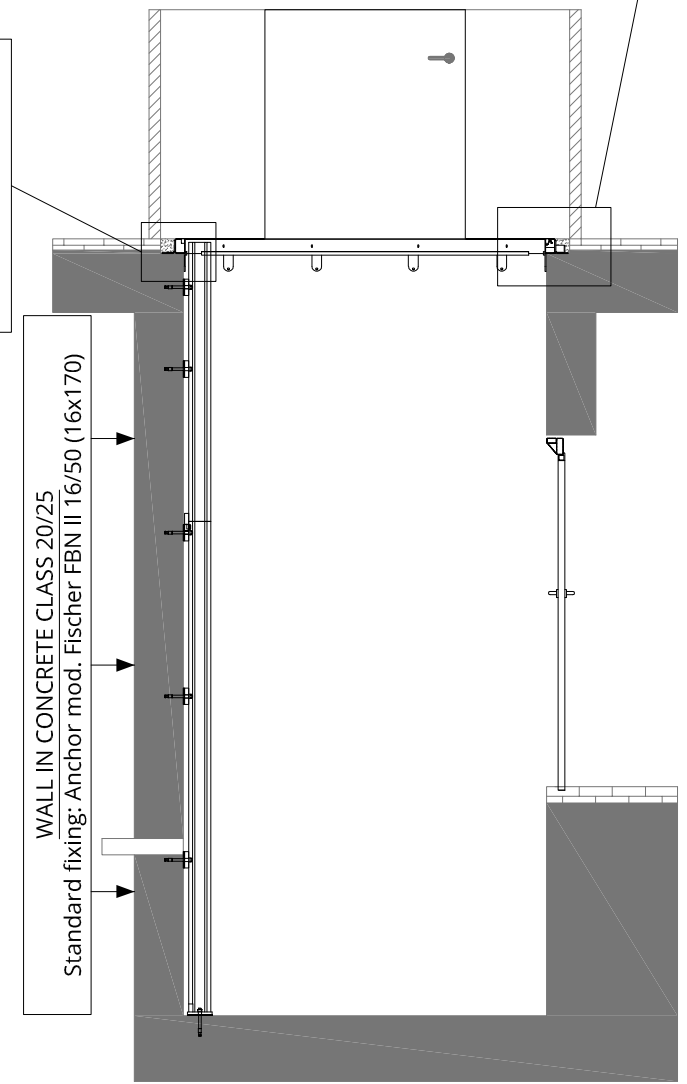

PREDISPORRE TUBO CORRUGATO Ø10cm FINO AL VANO TECNICO

Water drain pipe d.50

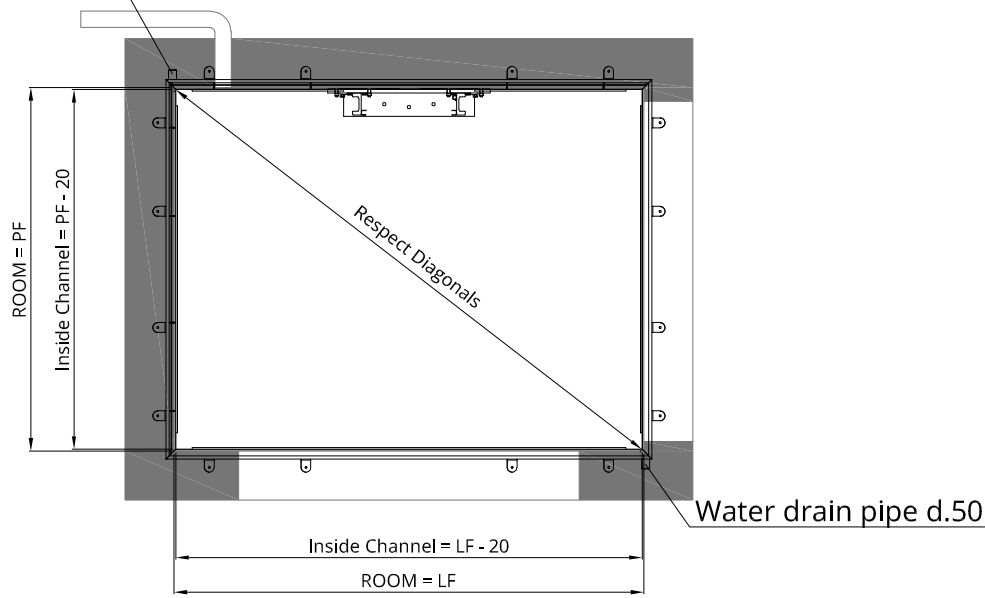

MARK THE ENTRANCES AND THE HEIGHT OF FLOOR

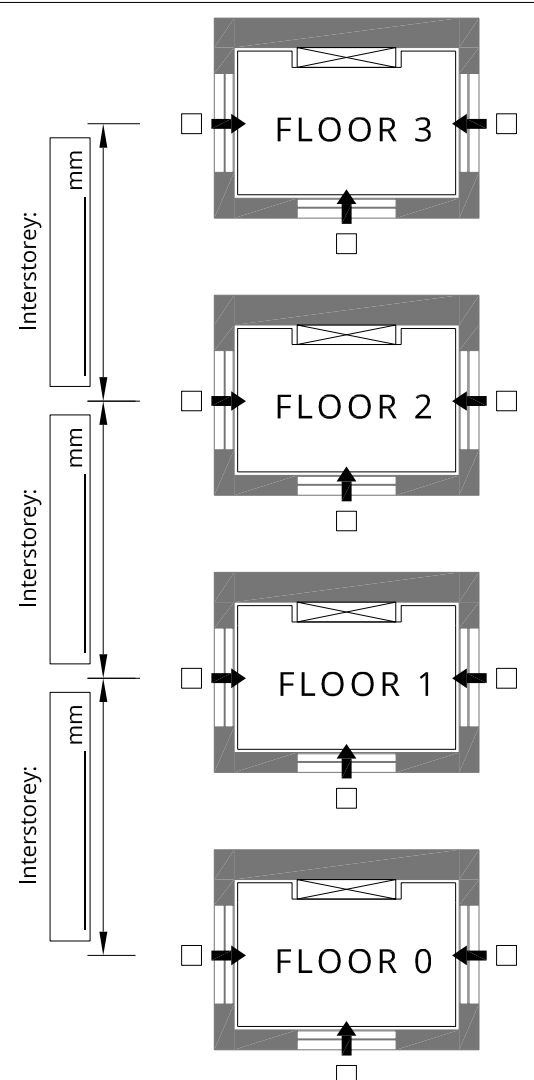

Motor	Tension-functioning	Starter	Suggested switch*	Rated current	Current starter
3kW	220 V - 3ph	Direct	3x16A id=0,3A	10	35
	380 V - 3ph	Direct	4x16A id=0,3A	5	22
4kW	220 V - 3ph	Direct	3x20A id=0,3A	16	50
	380 V - 3ph	Direct	4x16A id=0,3A	8	25
5,5kW	220 V - 3ph	Direct	4x25A id=0,3A	22	60
	380 V - 3ph	Direct	4x16A id=0,3A	11	35

**MODEL:**  UP15RT - 1500Kg  UP20RT - 2000Kg

Date: \_\_\_\_\_ Signature for approval: \_\_\_\_\_ **CE**

MISURE IN mm

FLATBED DIMENSION (grey area)

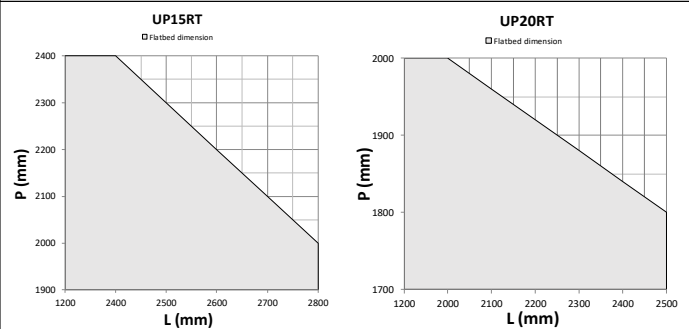

Force on the wall, Fx function of depth flatbed

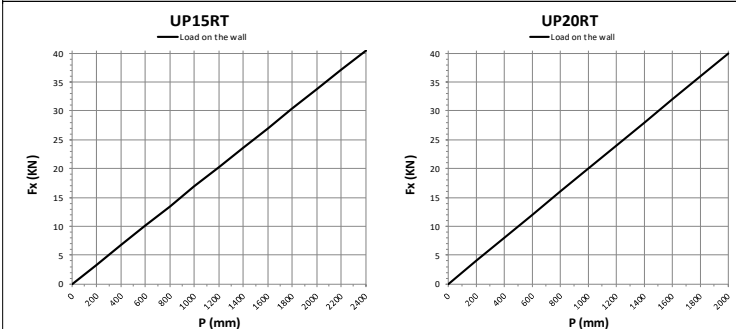

**UPDINAMIC** Via Modigliani, 22 - 37045 Legnago (VR) - Tel. 0442.59.01.29 - Fax. 0442.59.90.91  
www.updynamic.com - e-mail: info@updynamic.com

Q.T.A.	DESCRIZIONE:	Cliente:
	MODEL: UP15-20RT SPB	Uscirente:
	STROKE MAX: 12000mm	Data: 10/09/19
	PIT DETAILS UP SPB	Disegno n°:
		TAV-UP15-20RTSPB-PIT
		Sostituto dat.:
		Sostitutore it.: